

**Cutting Head Kit, P/N's 9001050, 9001051**

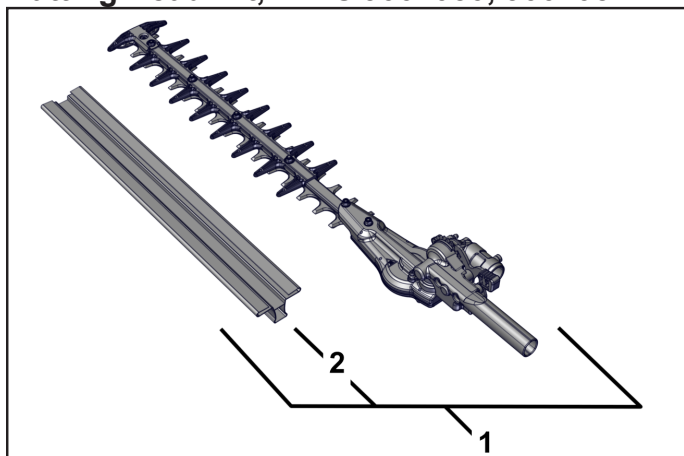

NO.	PART NUMBER	QTY.	DESCRIPTION
1	9001050	1	CUTTING HEAD KIT - ECHO
2	X495000770	1	+SCABBARD (Orange)
1	9001051	1	CUTTING HEAD KIT - SHINDAIWA
2	V4701120100	1	+SCABBARD (Red)

**Cutting Head Kit, P/N 9001050**

ECHO MODELS	SERIAL NUMBER RANGE
HCA-2620 Articulating Hedge Trimmer	U00315001001 and up.
99944200596 Articulating Hedge Trimmer Attachment	U02100001001 and up.

**Cutting Head Kit, P/N 9001051**

SHINDAIWA MODELS	SERIAL NUMBER RANGE
AH262 Articulating Hedge Trimmer	U02415001001 and up.
66003 Articulating Hedge Trimmer Attachment	U03000001001 and up.

**Procedure**

**⚠ WARNING**

*Hedge Trimmer blades are very sharp. Touching them may lead to severe personal injury. Avoid touching blades whenever possible, and always wear gloves to protect hands.*

Remove the existing cutting head assembly:

1. Remove locating screw (A) and loosen clamping screw (B).

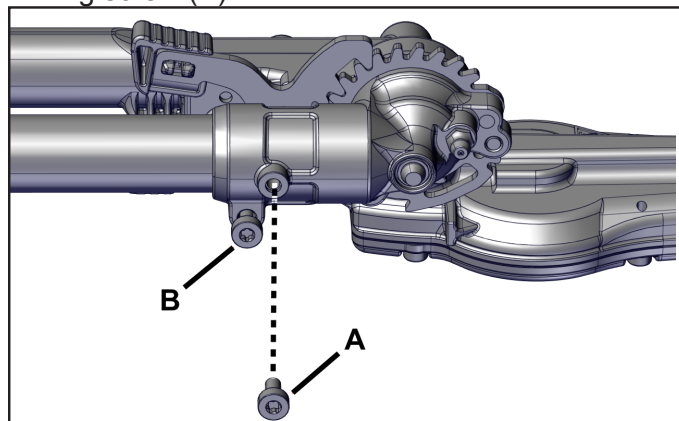

2. Remove the cutting head assembly.

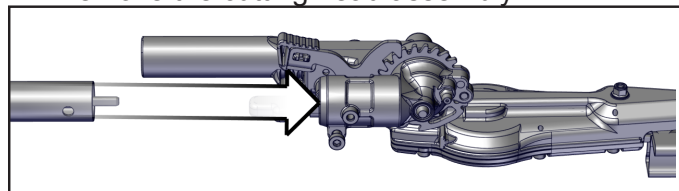

Install the new cutting head assembly:

1. Assemble the new cutting head assembly onto the drive shaft.

Note: Fully engage the flex drive cable to the input drive of the gear case.

2. Align the locating screw hole in the gear case with the locating hole of the drive shaft assembly.

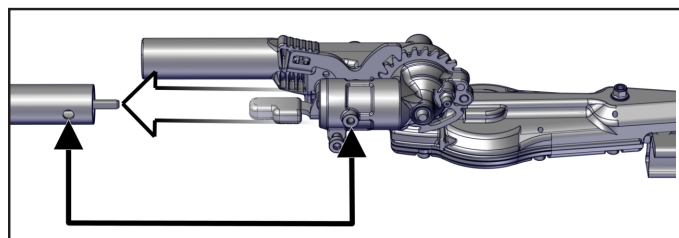

3. Install and tighten locating screw (A) and tighten clamping screw (B).

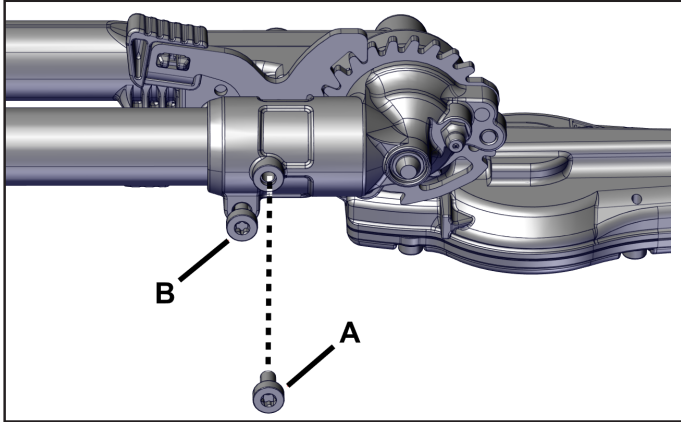

## **NOTICE**

*These cutting head assemblies are not interchangeable with other cutting head assemblies. Refer to your operator's manual for operation and maintenance.*